



AYUSA

FOR LEASE



AYUSA SLP XII



General Information

Name:	SLP XII
Description:	Industrial Building for Lease
Location:	Parque Industrial Colinas de San Luis
Total building:	52,823.57 sf / 4,907.43 sm
Land area:	161,460 sf / 15,000 sm
Available building area:	52,823.57 SF / 4,907.43 SM (Expandable to 91,086.37 sf / 8,462.13 sm)
Clear height:	30 ft / 9.14m
Dock doors:	2 docks capability for 2 more
Forklift Access:	1
Floor thickness:	As per client request
Roof type:	Multipanel
Substation:	As per client request
Office area / HVAC:	As per client request
Parking lot:	32 spaces
Fire Protection System	As per client request

General Layout

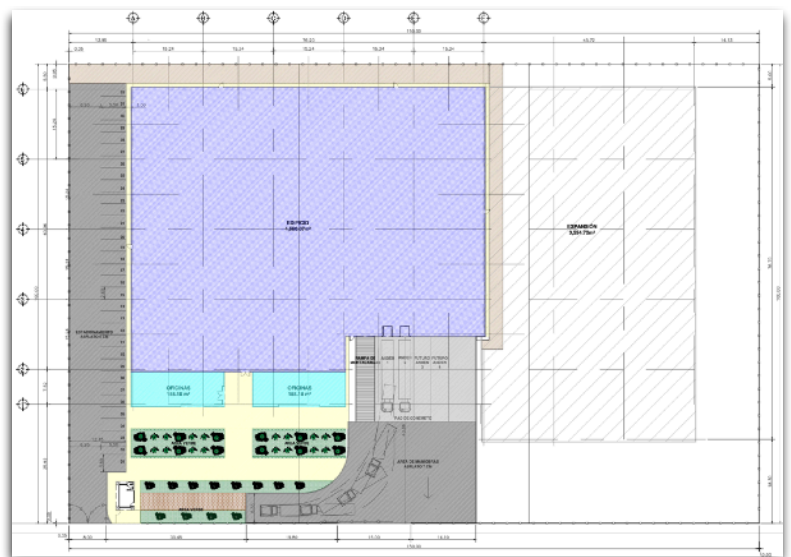

Contact Information

Oscar Echeverria
 Mobile: +52(442)146-9707
 Mex: +52 (442)-248-5288
 E-mail: oecheverria@grupoayusa.net

www.grupoayusa.com